

PORTER COUNTY - GPS CONTROL NETWORK

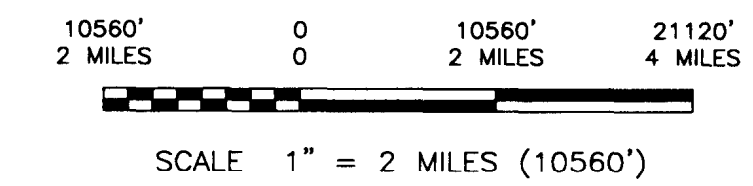
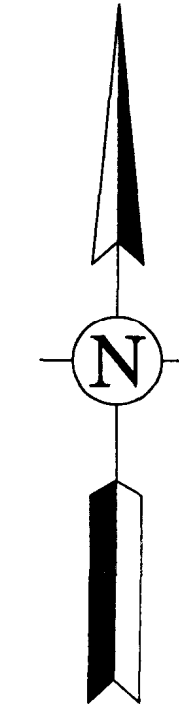
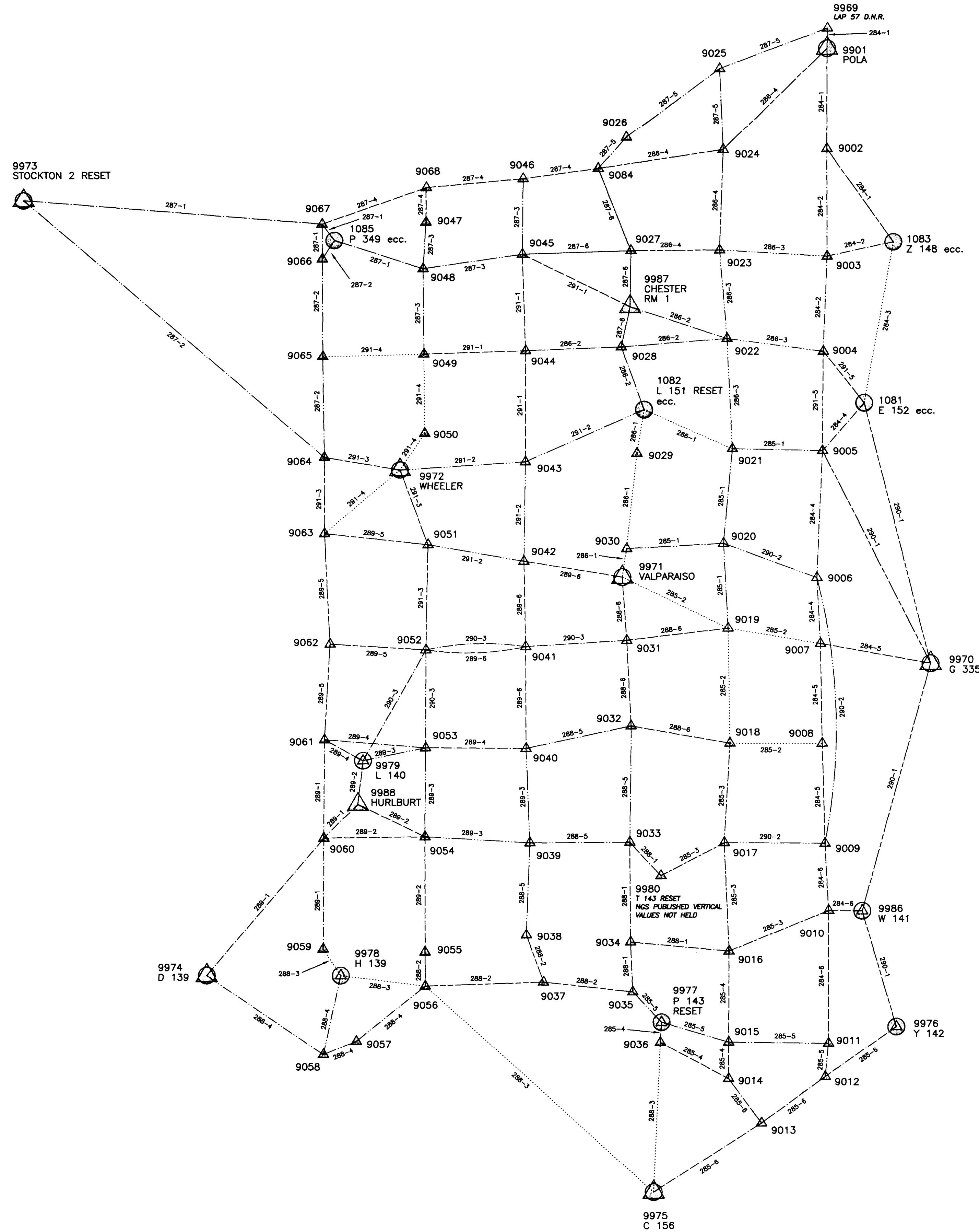

LEGEND

GPS BASELINE IDENTIFICATION EXAMPLE:
 9027 \triangle -----286-4----- \triangle 9023

THIS EXAMPLE REPRESENTS A GPS BASELINE OBSERVED BETWEEN STATION No. 9023 AND STATION No. 9027 ON THE FOURTH SESSION OF JULIAN DAY 286 (OCTOBER 13th) OF 1999. ALL BASELINES SHOWN ARE NON-TRIVIAL.

- \triangle = NEW GEODETIC CONTROL STATION
- \triangle = NGS ORDER B HORIZONTAL CONTROL STATION
- \circ = NGS VERTICAL CONTROL STATION OR ITS ECCENTRIC STATION
- ecc. = DENOTING A STATION ECCENTRIC TO THE PUBLISHED STATION WITH VERTICAL CONTROL VALUES TRANSFERRED
- D.N.R. = INDIANA DEPARTMENT OF NATURAL RESOURCES

PROJECT DIAGRAM

Geodetic Control Stations and GPS Baselines

DATE	PROJECT NO.	REVISIONS
OCT. 1999	9811002	GPS SURVEY FIELD OBSERVATIONS
PORTER COUNTY, INDIANA GPS CONTROL NETWORK 1999		
FILE: PORTER_NET.DWG		