

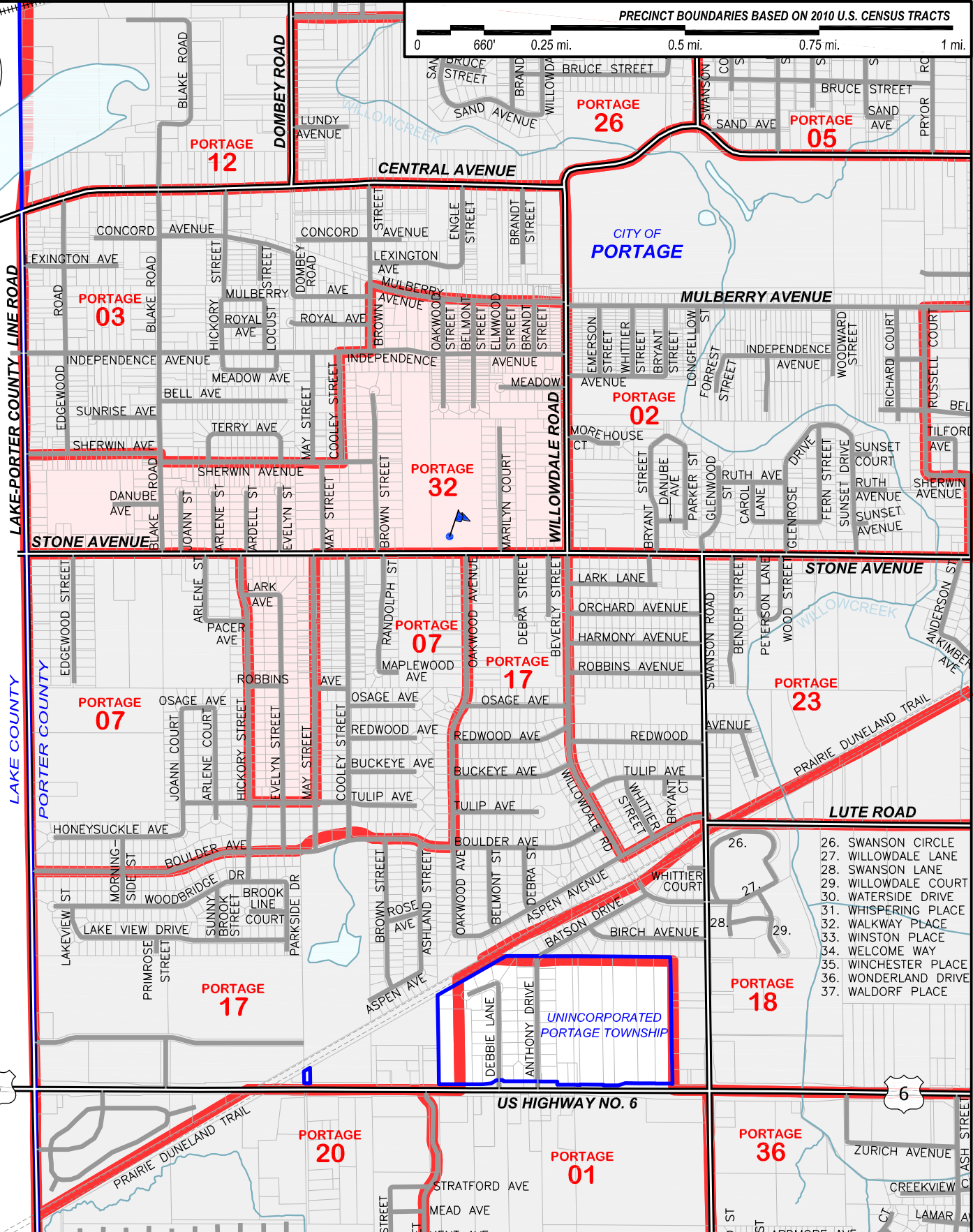

PRECINCT BOUNDARIES BASED ON 2010 U.S. CENSUS TRACTS

0 660' 0.25 mi. 0.5 mi. 0.75 mi. 1 mi.



- 26. SWANSON CIRCLE
- 27. WILLOWDALE LANE
- 28. SWANSON LANE
- 29. WILLOWDALE COURT
- 30. WATERSIDE DRIVE
- 31. WHISPERS PLACE
- 32. WALKWAY PLACE
- 33. WINSTON PLACE
- 34. WELCOME WAY
- 35. WINCHESTER PLACE
- 36. WONDERLAND DRIVE
- 37. WALDORF PLACE

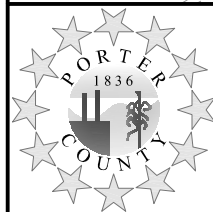

PORTER COUNTY SURVEYOR'S OFFICE
 KEVIN D. BREITZKE, P.E., L.S. - COUNTY SURVEYOR
 155 INDIANA AVENUE SUITE 303
 VALPARAISO, INDIANA 46383
 PHONE (219) 465-3560 FAX (219) 465-3811

PORTAGE TOWNSHIP PRECINCT NO. 32

Poll location: Fegley Middle School
 5384 Stone Avenue

Date: 01-01-2012
 Scale: 1:1320'
 Quarter Section No. N/A

Precinct lines (red) are based on 2010 US Census Data provided by the Indiana Election Division and county election officials.